

ACCESSORIES

D1 & D2 Type – Guage Damper



Max. Temperature: 120°C

Max. Pressure: 400 bar at 60°C

| Type | Connection Thread* |
|------|-----------------------------------|
| D1 | G ½ (G½" Female x G½" Male) |
| D2 | ½ NPT (½"NPT Female x ½"NPT Male) |

*Also available with connection thread G¼, G¾, and ¼NPT.

Parts Material

| | |
|----------------|-------|
| Body | SS316 |
| Screw plug | SS316 |
| O-ring | Viton |
| Adjusting stem | SS316 |

Dimension

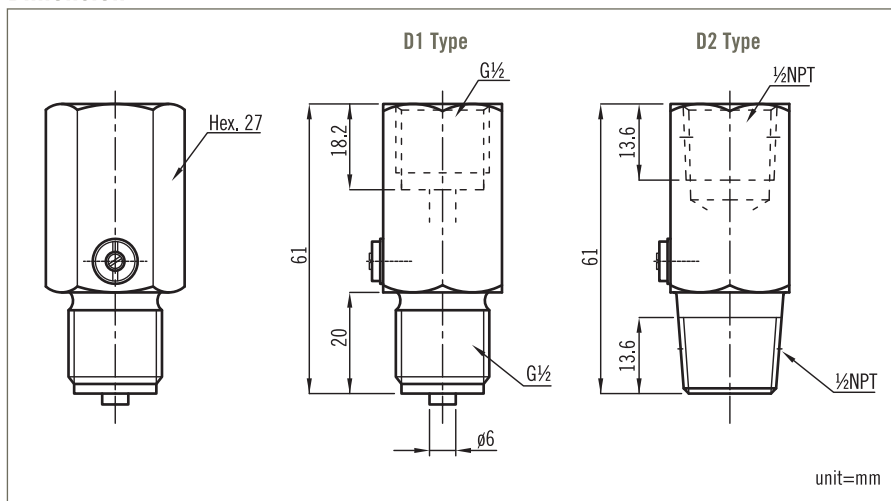

VT Type – Drain/Vent Valves



Drain/Vent Valves Material: SS316, and others on request.

Max. Temperature: 250°C

Max. Pressure: 100 bar at 60°C

Dimension

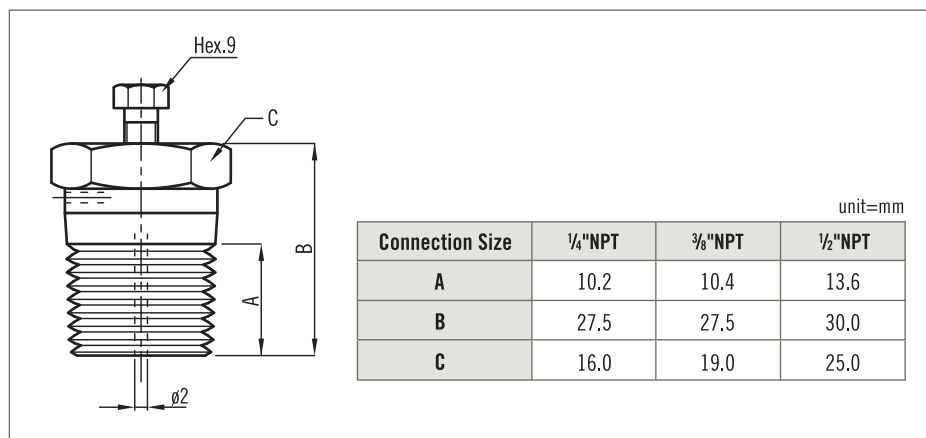

NN & BN Type – Reducing Adapter



A. NN Type – Thread NPT to Thread NPT

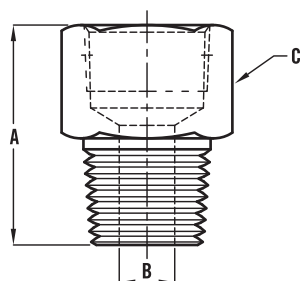

Ordering Information & Dimensions

| Ordering Code | Connection Size | A | B | C |
|---------------|---------------------------------|----|------|----|
| NN-1 | 1/8" NPT female x 1/4" NPT male | 29 | 4.8 | 23 |
| NN-2 | 1/8" NPT female x 3/8" NPT male | 32 | 4.8 | 23 |
| NN-3 | 1/8" NPT female x 1/2" NPT male | 36 | 4.8 | 23 |
| NN-4 | 1/8" NPT female x 3/4" NPT male | 36 | 4.8 | 29 |
| NN-5 | 1/4" NPT female x 1/8" NPT male | 29 | 4.8 | 23 |
| NN-6 | 1/4" NPT female x 3/8" NPT male | 34 | 7.1 | 23 |
| NN-7 | 1/4" NPT female x 1/2" NPT male | 38 | 7.1 | 23 |
| NN-8 | 1/4" NPT female x 3/4" NPT male | 38 | 7.1 | 29 |
| NN-9 | 3/8" NPT female x 1/8" NPT male | 32 | 4.8 | 23 |
| NN-10 | 3/8" NPT female x 1/4" NPT male | 34 | 7.1 | 23 |
| NN-11 | 3/8" NPT female x 1/2" NPT male | 41 | 9.6 | 23 |
| NN-12 | 3/8" NPT female x 3/4" NPT male | 41 | 9.6 | 29 |
| NN-13 | 1/2" NPT female x 1/8" NPT male | 36 | 4.8 | 27 |
| NN-14 | 1/2" NPT female x 1/4" NPT male | 38 | 7.1 | 27 |
| NN-15 | 1/2" NPT female x 3/8" NPT male | 38 | 9.6 | 27 |
| NN-16 | 1/2" NPT female x 3/4" NPT male | 45 | 11.9 | 29 |
| NN-17 | 3/4" NPT female x 1/8" NPT male | 36 | 4.8 | 35 |
| NN-18 | 3/4" NPT female x 1/4" NPT male | 38 | 7.1 | 35 |
| NN-19 | 3/4" NPT female x 3/8" NPT male | 41 | 9.6 | 35 |
| NN-20 | 3/4" NPT female x 3/4" NPT male | 45 | 15.7 | 35 |

unit=in(mm)

B. BN Type – Thread BSP(PF) to Thread NPT

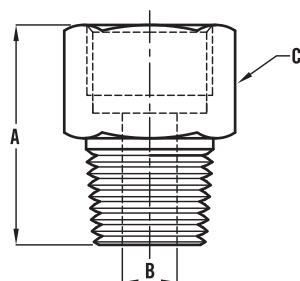

Ordering Information & Dimensions

| Ordering Code | Connection Size | A | B | C |
|---------------|-------------------------------------|----|------|----|
| BN-1 | 1/4" BSP(PF) female x 1/8" NPT male | 30 | 4.1 | 23 |
| BN-2 | 1/4" BSP(PF) female x 3/8" NPT male | 35 | 5.8 | 23 |
| BN-3 | 1/4" BSP(PF) female x 1/2" NPT male | 39 | 5.8 | 23 |
| BN-4 | 1/4" BSP(PF) female x 3/4" NPT male | 39 | 5.8 | 29 |
| BN-5 | 3/8" BSP(PF) female x 1/8" NPT male | 30 | 4.1 | 23 |
| BN-6 | 3/8" BSP(PF) female x 1/4" NPT male | 32 | 5.8 | 23 |
| BN-7 | 3/8" BSP(PF) female x 1/2" NPT male | 39 | 7.9 | 23 |
| BN-8 | 3/8" BSP(PF) female x 3/4" NPT male | 39 | 7.9 | 29 |
| BN-9 | 1/2" BSP(PF) female x 1/8" NPT male | 33 | 4.1 | 27 |
| BN-10 | 1/2" BSP(PF) female x 1/4" NPT male | 35 | 5.8 | 27 |
| BN-11 | 1/2" BSP(PF) female x 3/8" NPT male | 38 | 7.9 | 27 |
| BN-12 | 1/2" BSP(PF) female x 3/4" NPT male | 42 | 11.9 | 29 |
| BN-13 | 3/4" BSP(PF) female x 1/8" NPT male | 35 | 4.1 | 35 |
| BN-14 | 3/4" BSP(PF) female x 1/4" NPT male | 37 | 5.8 | 35 |
| BN-15 | 3/4" BSP(PF) female x 3/8" NPT male | 40 | 7.9 | 35 |
| BN-16 | 3/4" BSP(PF) female x 1/2" NPT male | 44 | 11.9 | 35 |

unit=in(mm)

NB & BB Type – Reducing Adapter



A. NB Type – Thread NPT to Thread BSP(PF)

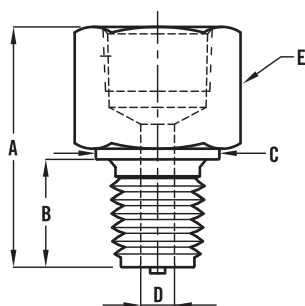

Ordering Information & Dimensions

| Ordering Code | Connection Size | A | B | C | D | E |
|---------------|---------------------------------|----|------|------|------|----|
| NB-1 | 1/8" NPT female x 1/4" BSP male | 30 | 11.2 | 18 | 4.1 | 23 |
| NB-2 | 1/8" NPT female x 3/8" BSP male | 32 | 11.2 | 21.6 | 4.1 | 23 |
| NB-3 | 1/8" NPT female x 1/2" BSP male | 36 | 14.2 | 25.9 | 4.1 | 27 |
| NB-4 | 1/8" NPT female x 3/4" BSP male | 36 | 15.7 | 32 | 4.1 | 35 |
| NB-5 | 1/4" NPT female x 1/4" BSP male | 32 | 11.2 | 18 | 5.8 | 23 |
| NB-6 | 1/4" NPT female x 3/8" BSP male | 34 | 11.2 | 21.6 | 5.8 | 23 |
| NB-7 | 1/4" NPT female x 1/2" BSP male | 38 | 14.2 | 25.9 | 5.8 | 27 |
| NB-8 | 1/4" NPT female x 3/4" BSP male | 38 | 15.7 | 32 | 5.8 | 35 |
| NB-9 | 3/8" NPT female x 1/4" BSP male | 35 | 11.2 | 18 | 5.8 | 23 |
| NB-10 | 3/8" NPT female x 3/8" BSP male | 37 | 11.2 | 21.6 | 7.9 | 23 |
| NB-11 | 3/8" NPT female x 1/2" BSP male | 41 | 14.2 | 25.9 | 7.9 | 27 |
| NB-12 | 3/8" NPT female x 3/4" BSP male | 41 | 15.7 | 32 | 7.9 | 35 |
| NB-13 | 1/2" NPT female x 1/4" BSP male | 39 | 11.2 | 18 | 5.8 | 23 |
| NB-14 | 1/2" NPT female x 3/8" BSP male | 41 | 11.2 | 21.6 | 7.9 | 23 |
| NB-15 | 1/2" NPT female x 1/2" BSP male | 45 | 14.2 | 25.9 | 11.9 | 27 |
| NB-16 | 1/2" NPT female x 3/4" BSP male | 45 | 15.7 | 32 | 11.9 | 35 |
| NB-17 | 3/4" NPT female x 1/4" BSP male | 39 | 11.2 | 18 | 5.8 | 23 |
| NB-18 | 3/4" NPT female x 3/8" BSP male | 41 | 11.2 | 21.6 | 7.9 | 23 |
| NB-19 | 3/4" NPT female x 1/2" BSP male | 45 | 14.2 | 25.9 | 11.9 | 27 |
| NB-20 | 3/4" NPT female x 3/4" BSP male | 45 | 15.7 | 32 | 15.7 | 35 |

unit=in(mm)

B. BB Type – Thread BSP(PF) to Thread BSP(PF)

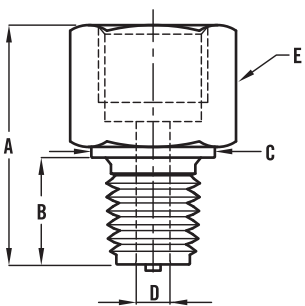

Ordering Information & Dimensions

| Ordering Code | Connection Size | A | B | C | D | E |
|---------------|---------------------------------|----|------|------|------|----|
| BB-1 | 1/4" BSP female x 3/8" BSP male | 30 | 11.2 | 21.6 | 5.8 | 23 |
| BB-2 | 1/4" BSP female x 1/2" BSP male | 35 | 14.2 | 25.9 | 5.8 | 23 |
| BB-3 | 1/4" BSP female x 3/4" BSP male | 36 | 15.7 | 32 | 5.8 | 35 |
| BB-4 | 3/8" BSP female x 1/4" BSP male | 33 | 11.2 | 18 | 5.8 | 23 |
| BB-5 | 3/8" BSP female x 1/2" BSP male | 35 | 14.2 | 25.9 | 7.9 | 27 |
| BB-6 | 3/8" BSP female x 3/4" BSP male | 36 | 15.7 | 32 | 7.9 | 35 |
| BB-7 | 1/2" BSP female x 1/4" BSP male | 36 | 11.2 | 18 | 5.8 | 23 |
| BB-8 | 1/2" BSP female x 3/8" BSP male | 36 | 11.2 | 21.6 | 7.9 | 23 |
| BB-9 | 1/2" NPT female x 3/4" BSP male | 39 | 15.7 | 32 | 11.9 | 35 |
| BB-10 | 3/4" BSP female x 1/4" BSP male | 37 | 11.2 | 18 | 5.8 | 23 |
| BB-11 | 3/4" BSP female x 3/8" BSP male | 37 | 11.2 | 21.6 | 7.9 | 23 |
| BB-12 | 3/4" BSP female x 1/2" BSP male | 40 | 14.2 | 25.9 | 11.9 | 27 |

unit=in(mm)